









1. Isolate and disconnect all live utilities (inc. building supplies and street lighting)
2. Main utilities diversions - HV, EHV, BT Openreach, Virgin
3. Temporary substation installed
4. Permanent substation installed
5. Foul and surface water sewer diversions
6. Gas isolated and not needed for the development
7. Supplies and services to Eel Pie Island to maintained throughout

	Existing 33kV HV cable
	Existing 11kV HV cable
	Existing water supply main
	Existing LP Gas
	Virgin
	BT Openreach
	Foul sewer
	Surface water sewer

This drawing has been produced for illustrative purposes only and is not based on accurate survey information. The layout is still subject to design development and this is deemed to be acknowledged by all parties if this drawing is used for legal purposes.

Existing locations of buildings, roads, waterways and parkland based on Ordnance Survey data (Stanfords OS MasterMap 28/05/2021) © Crown copyright and database rights 2021 OS Licence 100035409

Site boundary based on mark-up provided by LBRuT as part of Twickenham Riverside Invitation to Tender document, June 2019. Requires legal verification.

Proposed buildings and landscaping subject to design development, which may affect boundary conditions and areas. Wharf Lane podium edge subject to change.

Landscape design and levels subject to change following further design development.

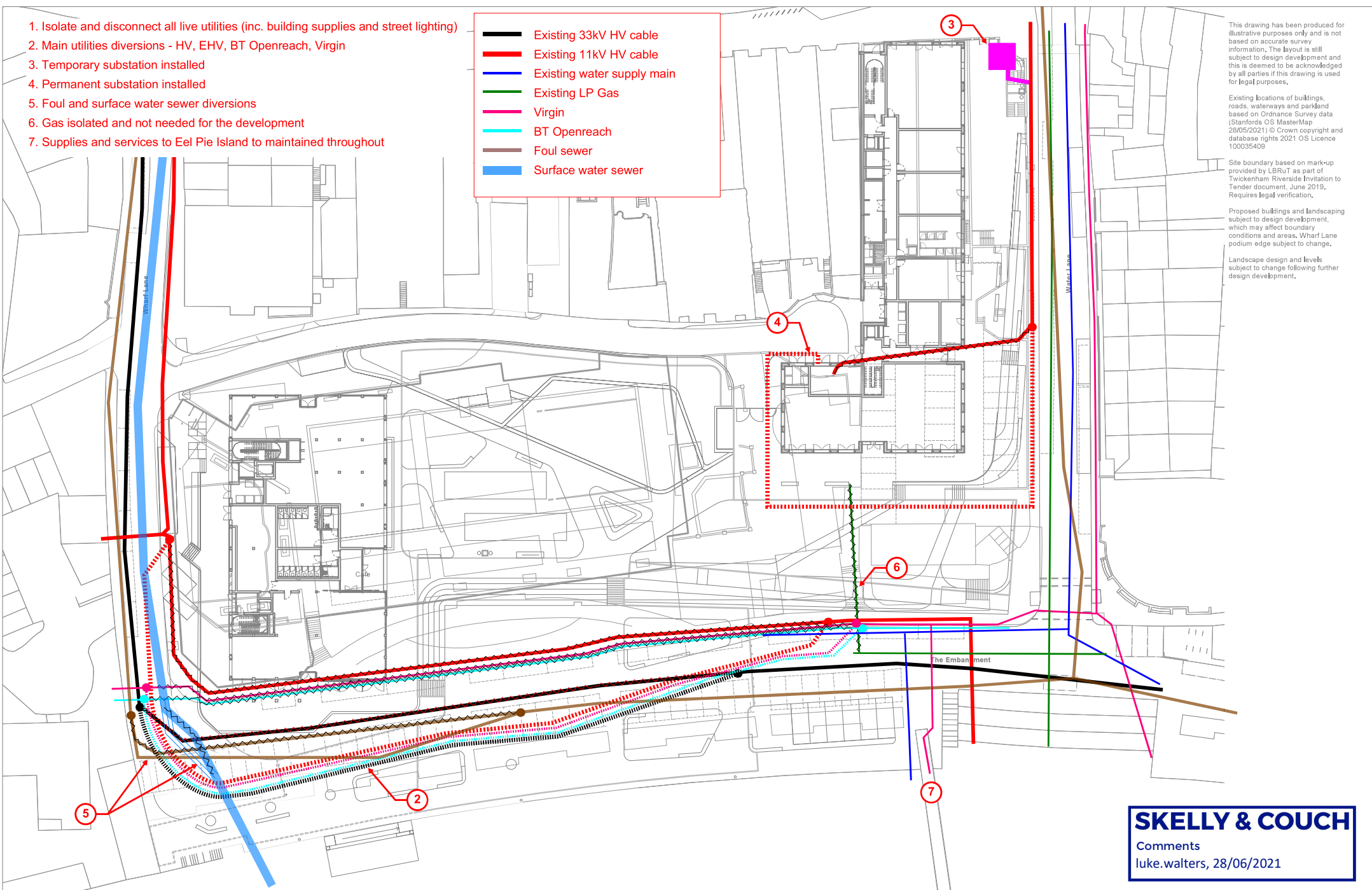

SKELLY & COUCH
 Comments
 luke.walters, 28/06/2021

Date	Rev.	Description	Approved By
28/06/2021	P01	M136 - Base to Assets	MS

Date	Rev.	Description	Approved By

DRAFT  

Project	Twickenham Riverside	Code	TRPS	File Name	Number	Rev.
Subject	Overlay Existing and Proposed & Existing and Proposed Gardens			TRPS-HAL-ZZ-00-DR-v	SK-128	P01
Architects	Hopkins Architects Limited 27 Broadway Terrace, London, W1H 1EG T: 020 7341 1831 E: ma@hopkinsarch.com		Date	06/24/21	Scale	1:250 at A1