



"This map is reproduced from Ordnance Survey material with the permission of the Controller of Her Majesty's Stationery Office © Crown copyright. Unauthorised reproduction infringes Crown copyright and may lead to prosecution or civil proceedings 100019441 [2016]."

PROPOSED ZONE S3
EXTENSION AREA (1)

PROPOSED ZONE S3
EXTENSION AREA (2)

LEGEND

BOROUGH BOUNDARY

ST MARGARETS – EXISTING PARKING SCHEMES

ZONE S OPERATIONAL:
MON – FRI
10am – 4.30pm

ZONE S2 OPERATIONAL:
MON – FRI
10am – 4.30pm

ZONE S3 OPERATIONAL:
MON – FRI
10am – 12pm

DEC 2016 – CONSULTATION

PROPOSED ZONE S3
EXTENSION AREAS

ST MARGARETS ROAD AND
RAILSHEAD ROAD –
POSSIBLE INCLUSION IN
ZONE S3

NORMANHURST DRIVE –
POSSIBLE EXTENSION OF
ZONE S2

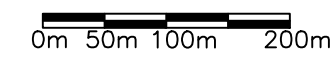
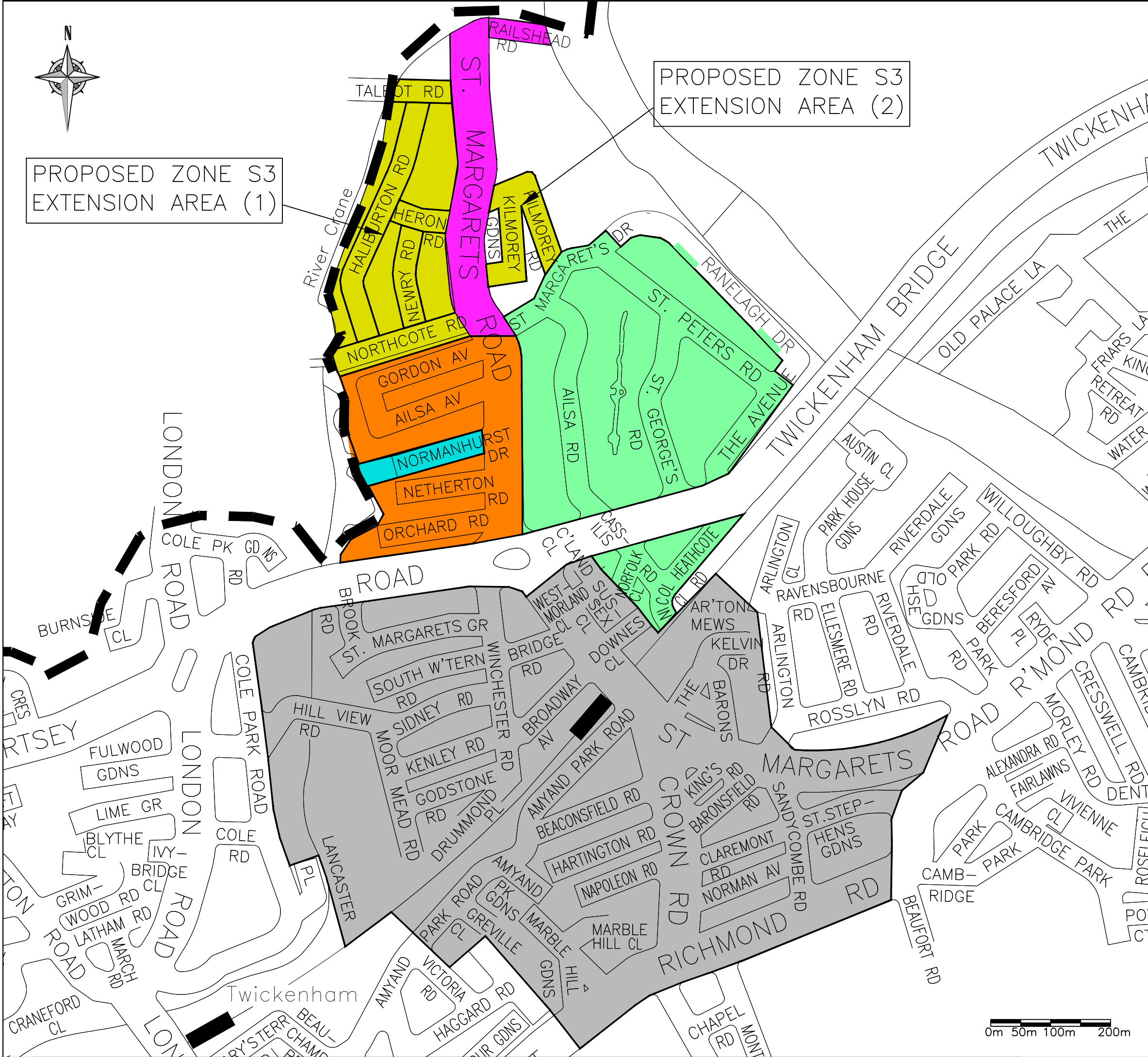

INITIAL ISSUE	T.S 10/2016	M.P 10/2016	M.P 10/2016	M.P 10/2016
		DRAFT	SCALE (AT A3 SIZE) N.T.S	
CLIENT	LONDON BOROUGH OF RICHMOND UPON THAMES			
PROJECT	ST MARGARETS PARKING SCHEMES			
DRAWING TITLE	ZONES S2 AND S3 REVIEW CONSULTATION			
ISSUING OFFICE	TWICKENHAM	DRAWING NUMBER	REVISION	
TELEPHONE	020 88911411	2318-S2S3-011116	-	