

to Mortlake Station/ Green

Sheen Lane

to Upper Richmond Road



Pedestrian routes between bus and train

pavement improvement (Highways Dept)

raised planter with annuals and shrubs
ground cover and climbing plants

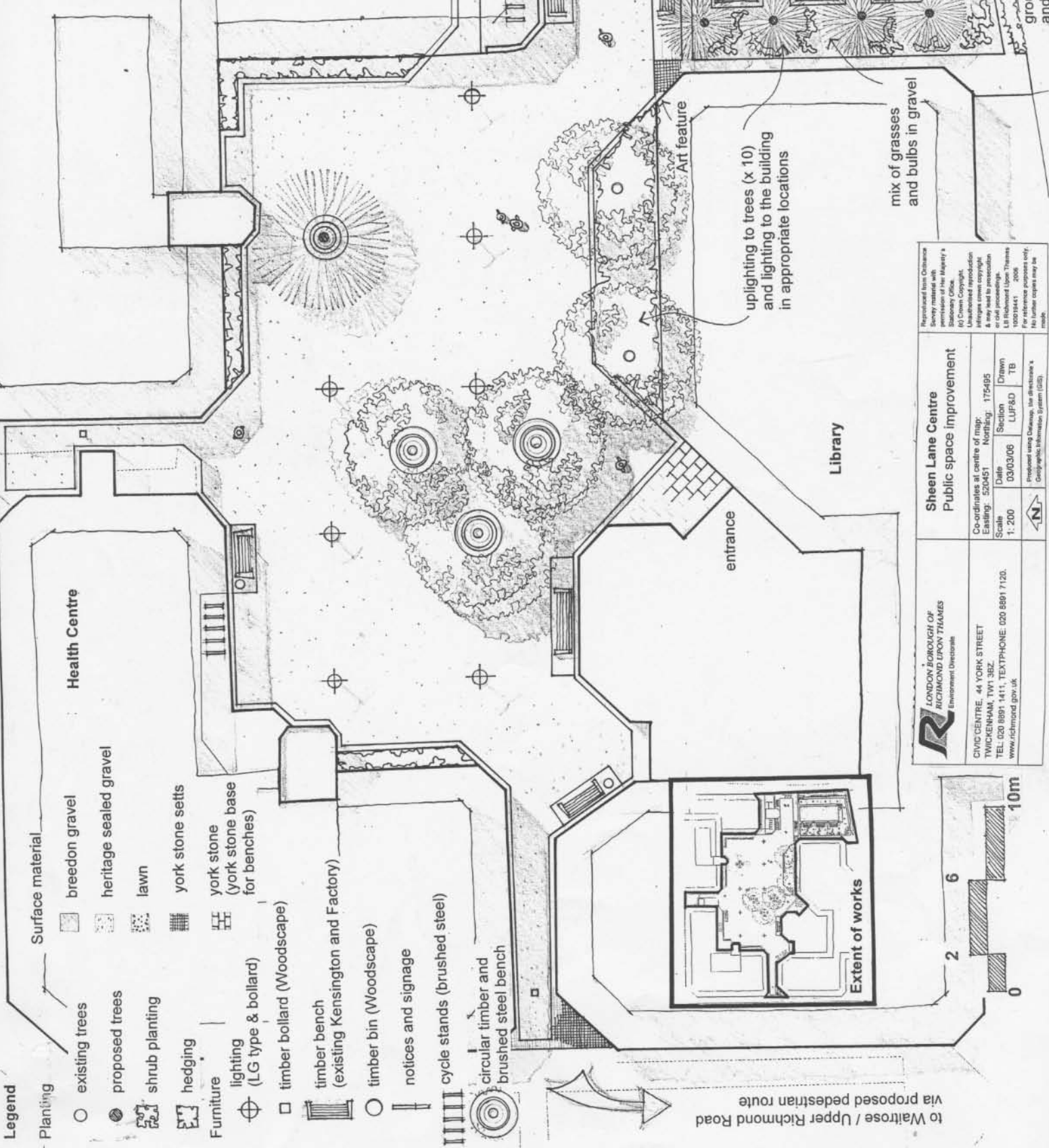

uplighting to trees (x 10) and lighting to the building in appropriate locations

mix of grasses and bulbs in gravel

Art feature

Library

entrance

Extent of works

Health Centre

- Legend**
- Planting**
- existing trees
 - proposed trees
 - shrub planting
 - hedging
- Furniture**
- lighting (LG type & bollard)
 - timber bollard (Woodscape)
 - timber bench (existing Kensington and Factory)
 - timber bin (Woodscape)
 - notices and signage
 - cycle stands (brushed steel)
 - circular timber and brushed steel bench

- Surface material**
- breedon gravel
 - heritage sealed gravel
 - lawn
 - york stone setts
 - york stone (york stone base for benches)

Reproduced from Outline Survey material with permission of the Mayor's Office for London.
© Crown Copyright.
Unauthorised reproduction of this document is prohibited. It may be used for personal or non-commercial purposes only. For reference purposes only. No further copies may be made.

Sheen Lane Centre Public space improvement	
Co-ordinates at centre of map: Easting: 520451 Scale: 1: 200	Northings: 175495 Section: LUF&D Drawn: TB
Date: 03/03/06	Drawn: TB
Prepared using Cadswop, the architect's CAD/CAM information system (GIS).	

RICHMOND BOROUGH OF
Environment Directorate

CIVIC CENTRE, 44 YORK STREET
TWICKENHAM, TW1 3EZ
TEL: 020 8891 1411, TEXTPHONE: 020 8891 7120
www.richmond.gov.uk

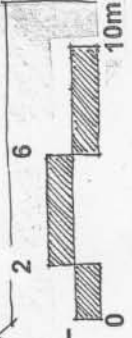

to Waitrose / Upper Richmond Road
via proposed pedestrian route