

### Translation Advice

If you have difficulty understanding this publication, please visit reception at the address below where we can arrange a telephone interpreting service.

Nese keni veshtersi per te kuptuar kete botim, ju lutemi e jani ne recepcionin ne adresen e shenuar me poshte ku ne mund te organizojme perkthime nepermjet telefonit.

Albanian

إذا كانت لديك صعوبة في فهم هذا المنشور، فنرجو زيارة الإستقبال في العنوان المعطى أدناه حيث بإمكاننا أن نرتب لخدمة ترجمة شفوية هاتفية.

Arabic

এই প্রকাশনার অর্থ বুঝতে পারায় যদি আপনার কোন সমস্যা হয়, নিচে দেওয়া ঠিকানায় রিসেপশন-এ চলে আসুন যেখানে আমরা আপনাকে টেলিফোনে দোভাষীর সেবা প্রদানের ব্যবস্থা করতে পারবো।

Bengali

اگر در فهمیدن این نشریه مشکلی دارید لطفاً به مین پذیرش در آدرس قید شده در زیر مراجعه نمایید تا ترتیب ترجمه تلفنی برایتان فراهم آورده شود:

Farsi

જો તમને આ પુસ્તિકાની વિગતો સમજવામાં મુશ્કેલી પડતી હોય તો, કૃપયા નીચે જણાવેલ સ્થળના રિસેપ્શન પર આવો, જ્યાં અમે ટેલિફોન પર ગુજરાતીમાં ઇન્ટરપ્રિટીંગ સેવાની ગોઠવણ કરી આપીશું.

Gujarati

ਜੇਕਰ ਤੁਹਾਨੂੰ ਇਸ ਪਰਚੇ ਨੂੰ ਸਮਝਣ ਵਿਚ ਮੁਸ਼ਕਲ ਪੇਸ਼ ਆਉਂਦੀ ਹੈ ਤਾਂ ਹੇਠਾਂ ਦਿੱਤੇ ਗਏ ਪਤੇ ਉੱਪਰ ਰਿਸੈਪਸ਼ਨ 'ਤੇ ਆਓ ਜਿੱਥੇ ਅਸੀਂ ਟੈਲੀਫੋਨ ਤੇ ਗੱਲਬਾਤ ਕਰਨ ਲਈ ਇੰਟਰਪ੍ਰਿਟਰ ਦਾ ਪ੍ਰਬੰਧ ਕਰ ਸਕਦੇ ਹਾਂ।

Punjabi

اگر آپ کو اس اشاعت کو سمجھنے میں کوئی مشکل ہے تو، براہ کرم نیچے دیئے ہوئے ایڈریس کے استقبال پر جا کر ملیئے، جہاں ہم آپ کیلئے ٹیلیفون انٹرپرائزنگ سروس (ٹیلیفون پر ترجمانی کی سروس) کا انتظام کر سکتے ہیں۔

Urdu

Please contact us if you need this leaflet in Braille, large print, on audio tape or in another language.

Phone: 020 8891 7500 or Minicom: 020 8891 7539.

Education and Children's Services, First Floor, Regal House, London Road, Twickenham, TW1 3QB.

This newsletter provides an update on progress made over the last 4 months with the Teddington School rebuild and to inform on the next stages of the programme.

#### New Designs for the School

The architects BDP have now completed the RIBA (Royal Institute of British Architects) Stage C design works on the preferred option from the consultation event held in April 2007 for the new school, which were accepted by the Teddington School rebuild committee and the Council, subject to some details that are currently being addressed. A planning application is now scheduled to be submitted to the Council's planning department on 3rd September 2007.

#### Scheme Design

The school site will include two all-weather sports pitches. The new building will be built on the site of the currently floodlit pitch adjacent to Trowlock Way and floodlighting will be installed to the currently non-floodlit pitch which will be retained. The old school building will be demolished to make way for a second on-site all-weather sports pitch. A Multi-use games area (MUGA) to be used for netball, basketball and football will be provided adjacent to the school on the Broom Road Recreation Ground.

The site will contain a welcoming landscaped pedestrian and cycle access to the new building from Broom Road. There will be extensive cycle parking at the entrance to the school building which is intended to encourage students to cycle to school. There will also be 47 parking spaces for school staff only and a lay-by for two coaches or buses on-site.

The building will be shaped by three distinctive 'Pebbles' that will identify the school's specialist teaching areas - one for the Physical Education/Performing Arts department, one for art and design, and one housing the science laboratories. The school building's main entrance will draw students and visitors into a central hub area which will be overlooked on two sides by walkways lining the two classroom blocks. One of these teaching wings will form the highest part of the school at 4 storeys. The main communal activities including assembly, café, dining, the discovery centre and the computer hall will be located on the ground floor and will feed off the central core.

The building will contain a separate entrance for sports and leisure users so that these facilities are accessible out of school hours.



Photomontage of the new school as seen from across the Broom Road Recreation Ground

A new Habitat Area for the school, to contain a wetland area, will make use of the existing asset adjacent to the River Thames. Its access will be controlled, and it will be used for teaching, recreation, and outdoor performance. Within the overall school site, there will be far more outdoor recreation space than at present.

It is estimated that completion of the new school is achievable by the end of 2009. The existing school will remain in operation until the new one is ready to be opened so that there is a smooth transition from one building to the other.

#### Local Impacts

The repositioning of the floodlighting facilities has been raised as an issue by local residents who were concerned that the local amenity would be negatively affected by new light and noise impacts when compared to the existing situation. In order to address this, acoustic and lighting impact reports were produced and have now informed the school design and have been presented to local residents groups.

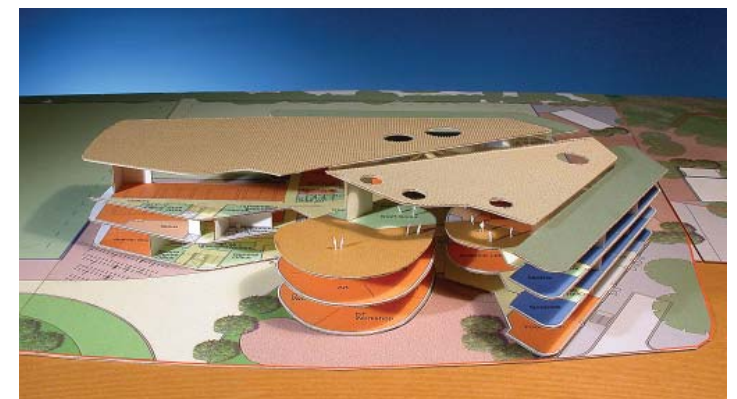

Illustrative model of the new school building from the Broom Road Recreation Ground



Illustrative masterplan and siting layout

The acoustic report assessed current background noise and intermittent noise during a normal school week. It was concluded that in order to ensure that new noise levels did not exceed acceptable levels, an acoustic barrier running the length of the all-weather sports pitches would ensure that no neighbouring property is more disrupted than at present; in fact for many it would improve upon the existing situation. This barrier would be 4m high and run along the length of the school boundary with the back gardens of properties on Melbourne Road. The noise levels were calculated using a model that assessed typical noise levels based upon the circumstances of the pitch. The barrier would extend to the back of the relocated hockey club pavilion to further ensure there is no disruption from its evening use, and also for a

35m length along the pitch fronting onto Broom Road. This was estimated to be an appropriate length to best balance out the noise mitigation and the open aesthetics provided by a new all-weather sports pitch in this location. This barrier would effectively resemble a fence and would likely be of timber construction, which will be screened through new tree planting.

The lighting report demonstrated that of the two all-weather sports pitches within the proposed development, floodlighting the one closest to Broom Road would not be possible without producing obtrusive light to adjacent properties exceeding good practice recommendations not only for rural but also for urban settings. This effectively ruled

out the second pitch to accommodate floodlighting facilities. The report then assessed the potential impact of floodlighting the existing all-weather sports pitch. With careful positioning and choice of light fittings the proposed pitch lighting would meet all the stringent requirements to limit obtrusive light for a rural environment. The report also estimated that the use of a 4m high acoustic fence would further decrease the light spillage into the neighbouring properties and avoid the direct view of the lit pitch from the first floor window.

### Sustainable Development

In order to satisfy the requirements that at least 10% of predicted site CO2 emissions are reduced, as required by government policy, a number of measures are being implemented. The embodied energy of the construction materials, the building whole life costs, water usage and carbon emissions will be reduced wherever possible. There is also a desire to achieve a BREEAM rating of "Excellent" (a method to assess the environmental impacts of developments), and to achieve at least 10% on-site production of the site's energy needs through renewables. The school building will also include green or brown roofs to encourage on-site biodiversity, and the use of sustainable modes of transport will be encouraged as much as possible.

### Consultation

Comments on the proposed scheme continue to be received and these are shared with the rebuild committee and council to inform all decisions taken.

Consultation is ongoing with local residents and other stakeholders. A meeting was held on 1 August 2007 with representatives of Broom Road, Melbourne Road and Trowlock Island to update them on the design for the school and discuss any issues with the school design.

The proposal was presented on 20 June 2007 to an independent Design Panel consisting of local architects and environmentalists. The Design Panel was supportive of the proposals and considered it a good strategy when taking into account the constraints that the scheme must overcome. A few issues were raised which have now been addressed. The scheme will be presented to a second Design Panel on 22 August 2007, in time for any potential change to be made prior to the submission of the planning application.

An exhibition will now be held in mid-September 2007 to coincide with the submission of the planning application and the planning department's own statutory consultation period. There will be a staffed exhibition on the evening of Thursday 13 September 2007 from 4pm to 8pm at Teddington School itself where the opportunity will be given for all to find out more and ask questions to the rebuild team. In addition, there will be unmanned displays the week commencing Monday 17 September at Teddington Library (Waldegrave Road, Teddington) and the Civic Centre Atrium (York Street, Twickenham) for one week.

### Further Information

Regular updates on the development of the scheme are posted on both the Council and Teddington School websites:

- [http://www.richmond.gov.uk/building\\_schools\\_for\\_the\\_future\\_newsletter\\_updates.htm](http://www.richmond.gov.uk/building_schools_for_the_future_newsletter_updates.htm)
- <http://www.teddington.richmond.sch.uk/newschool.htm>

Further comment on the proposals can be sent by e-mail to [teddingtonschool@bdp.co.uk](mailto:teddingtonschool@bdp.co.uk). Alternatively, contact Claire Briggs at the London Borough of Richmond-upon-Thames on 020 8891 7563 or write to: Claire Briggs, Education and Children's Services, London Borough of Richmond upon Thames, First floor, Regal House, London Road, Twickenham TW1 3QB.



Illustrative elevation of the proposed school from the Broom Road Recreation Ground and partly from Trowlock Island illustrating potential materials, heights, roof and fenestration. This elevation seeks to illustrate the different materials and textures that would appear from the outside of the school.