

MORTLAKE

CONTROLLED PARKING ZONE (CPZ) REVIEW

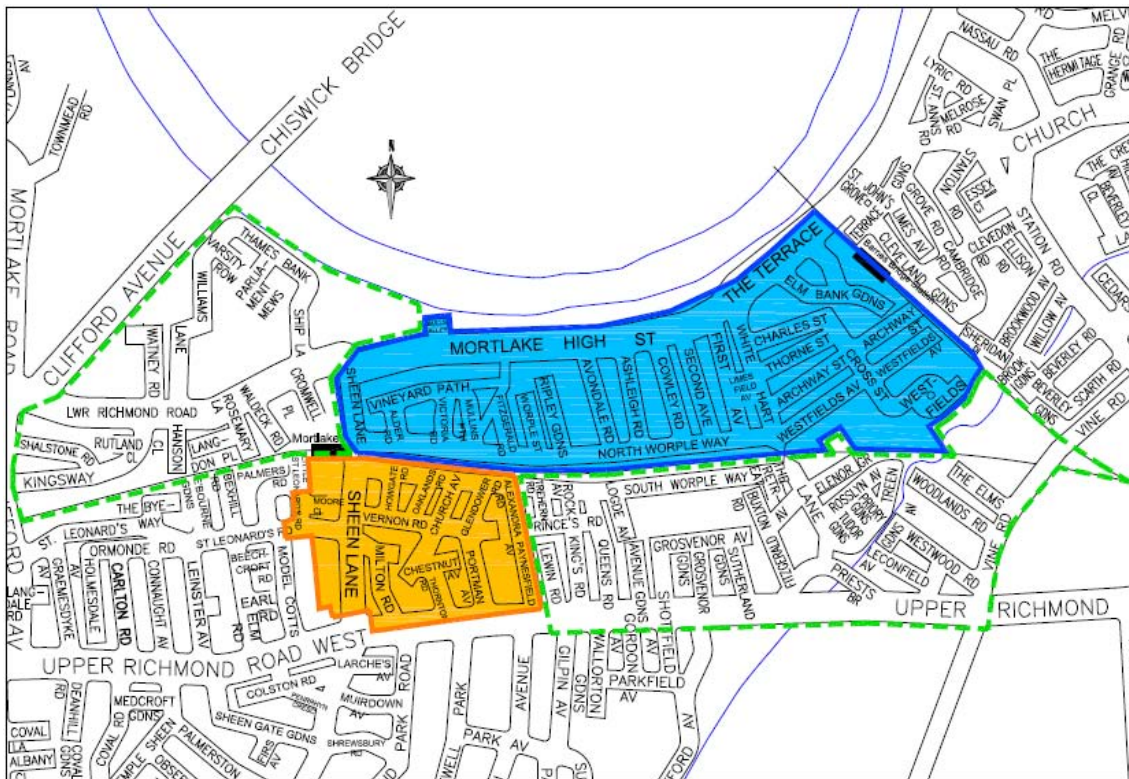

Consultation Area for Possible CPZ / CPZ extension



**Existing Mortlake CPZ - Zone M
(Mon-Fri, 9am-11am)**



**Existing East Sheen CPZ - Zone ES
(Mon-Fri, 10am-4:30pm)**

HAVE YOUR SAY

**PLEASE RETURN QUESTIONNAIRE BY
Friday 1 May 2009**

1. Objectives of the Consultation

The Mortlake controlled parking zone (zone M) came into operation in May 2008. The Council is now reviewing the operation of this controlled parking zone (CPZ).

As part of the review, the Council is also consulting on whether or not a CPZ should be introduced in roads outside the Mortlake CPZ.

The purpose of this consultation is to seek the views of residents and businesses situated within the green dotted boundary shown on the front of this document to see whether they would wish to have a CPZ introduced in their road.

Should the results of this consultation show support for a CPZ to be progressed further, then this could be in the form of an extension to the Mortlake CPZ and/or the East Sheen CPZ.

Whether you live or work in the area, whether you own a car, walk, cycle or use public transport, we want to hear your views.

Plans showing the existing layout of parking areas and yellow lines in the Mortlake CPZ will be available for inspection at the Sheen Lane Centre, Sheen Lane, East Sheen and at the Council offices, Civic Centre, 44 York Street, Twickenham during opening hours. The plans will also be available for inspection on the Council's website www.richmond.gov.uk/mortlake_cpz_review from 30 March 2009.

Please read the explanatory notes below and refer to the map on the front cover before completing the questionnaire.

2. How a CPZ Works

A CPZ prevents all-day commuter parking and provides priority parking space for residents and their visitors, short term visitors and businesses. It can also improve junction safety. Introducing a CPZ is a way of dealing with parking problems and making our environment safer.

Parking areas are usually designated on street for residents, businesses and visitors. At locations where it is unsafe to install parking areas such as at junctions and narrow sections of carriageway, yellow lines will be installed.

The Council enforces the borough's CPZs by employing civil enforcement officers. Penalty charge notices are issued to vehicles parked in contravention such as those parked on yellow lines and parked in parking places without valid permits, or not paying as required. This approach ensures that our roads are kept free from dangerous parking and priority for parking is given to the residents, businesses and visitors to the area.

The hours of control are dependent on the needs of an area. CPZs which operate for a short part of the day (e.g. 2 hours, Monday to Friday 9am to 11am) can prevent all-day commuter parking. However, longer controls (e.g. Monday to Friday 10am to 4.30pm) provide more protection in areas such as shopping centres and/or popular areas of interest such as parks or river walks.

Permits can be bought by residents for their vehicles and for their visitors' vehicles. Permits can also be bought by businesses. Parking provision is made for visitors in the

form of free short stay parking places and/or paid for parking places. Paid for parking places require payment to a pay-and-display machine.

There are advantages and disadvantages of CPZs:

Advantages

- Prevents all-day commuter parking
- Reduces the number of abandoned vehicles
- Improves access for vehicles especially emergency service and refuse vehicles
- Improves highway safety and reduces inconsiderate and indiscriminate parking
- Generally improves parking conditions for the community
- Encourages the use of vehicles that produce low CO₂ emissions (see Section 3 "Cost of permits")

Disadvantages

- Displacement effect to nearby uncontrolled roads
- Having to pay for a parking permit
- Street clutter (signs and lines)
- Can reduce on-street parking space
- Does not guarantee a parking space to permit holders

For further information on CPZs, please visit our website at www.richmond.gov.uk or call 08456 122 660.

PLEASE LET US HAVE YOUR VIEWS BY COMPLETING AND RETURNING THE ENCLOSED QUESTIONNAIRE ON OR BY FRIDAY 1 MAY 2009.

3. Cost of permits

The cost of permits is based on factors which include the following:

- The hours of operation of the Controlled Parking Zone
- The duration of the permit being purchased
- Whether the permit is the first or subsequent for your household or business
- The carbon dioxide emissions or cylinder capacity of the vehicle (see tables 1-5 below)

Tables 2-5 below give an indication of the permit charges likely to be applied from 1 April 2009 for CPZs typically operating for 2 hours and for more than 4 hours during weekdays.

There is an additional charge of 50% for second and subsequent permits purchased per household, business or organisation details of which are included in the tables.

Further information on the parking permit charges structure can be obtained by contacting the Council on 08456 122 660 or by visiting the Council's website at www.richmond.gov.uk.

Resident Visitor Permits cost £11 per book of ten half day permits. For residents aged 60 years and over a 50% discount applies.

3. Cost of permits (cont'd)

Please note that the information provided on parking permit charges refers to the bands which are likely to be introduced on 1 April 2009. For current charging bands, please contact the Council on 08456 122 660 or refer to the website www.richmond.gov.uk

NB: If you are unsure of your vehicles emissions details can be found on www.smmt.co.uk

CO ₂ Charging Bands	
TABLE 1 Vehicles registered on or after 1 March 2001	
CO ₂ Value	Vehicle Band
less than or equal to 100g/km	A
More than or equal to 101g/km but less than or equal to 110g/km	B
More than or equal to 111g/km but less than or equal to 120g/km	C
More than or equal to 121g/km but less than or equal to 130g/km	D
More than or equal to 131g/km but less than or equal to 140g/km	E
More than or equal to 141g/km but less than or equal to 150g/km	F
More than or equal to 151g/km but less than or equal to 160g/km	G
More than or equal to 161g/km but less than or equal to 170g/km	H
More than or equal to 171g/km but less than or equal to 180g/km	I
More than or equal to 181g/km but less than or equal to 200g/km	J
More than or equal to 201g/km but less than or equal to 225 g/km	K
More than or equal to 226g/km but less than or equal to 255 g/km	L
More than to 255g/km	M

Residents Permits Charges for Vehicles Registered After 1 March 2001						
TABLE 2 Type of vehicle – Band by CO ₂ emissions	First Vehicle per household			Second and subsequent vehicle		
	% change to current charge	2 hr Zone Base Price £45/year	Over 4 hr Zone Base Price £75/year	% <u>increase</u> to permit price	2 hr Zone Base Price £45/year	Over 4 hr Zone Base Price £75/year
A	FREE	£0	£0	FREE	£0	£0
B & C	- 50%	£22.50	£37.50	+50%	£33.75	£56.25
D, E & F	- 10%	£40.50	£67.50	+50%	£60.75	£101.25
G	+10%	£49.50	£82.50	+50%	£74.25	£123.75
H & I	+30%	£58.50	£97.50	+50%	£87.75	£146.25
J & K	+50%	£67.50	£112.50	+50%	£101.25	£168.75
L & M	+200%	£135.00	£225.00	+50%	£202.50	£337.50

Business Permits Charges for Vehicles Registered After 1 March 2001						
TABLE 3 Type of vehicle – Band by CO ₂ emissions	First Vehicle per household			Second and subsequent vehicle		
	% change on current charge	2 hr Zone Base Price £140/year	Over 4 hr Zone Base Price £240/year	% <u>increase</u> to permit price	2 hr Zone Base Price £140/year	Over 4 hr Zone Base Price £240/year
A	FREE	£0	£0	FREE	£0	£0
B & C	- 50%	£70	£120	+50%	£105.00	£180.00
D, E & F	- 10%	£126	£216	+50%	£189.00	£324.00
G	+10%	£154	£264	+50%	£231.00	£396.00
H & I	+30%	£182	£312	+50%	£273.00	£468.00
J & K	+50%	£210	£360	+50%	£315.00	£540.00
L & M	+200%	£420	£720	+50%	£630.00	£1080.00

3. Cost of permits (cont'd)

Residents Permits Charges for Vehicles Registered Before 1 March 2001						
TABLE 4	First Vehicle per household			Second and subsequent vehicle		
Type of vehicle – Band by engine capacity	% change on current charge	2 hr Zone Base Price £45/year	Over 4 hr Zone Base Price £75/year	% increase to permit price	2hr Zone Base Price £45/year	Over 4 hr Zone Base Price £75/year
<1000cc	-50%	£22.50	£37.50	+50%	£33.75	£56.25
1001cc to 1550cc	-30%	£31.50	£52.50	+50%	£47.25	£78.75
1551cc to 1800cc	-20%	£36.00	£60.00	+50%	£54.00	£90.00
1801cc to 2400cc	+10%	£49.50	£82.50	+50%	£74.25	£123.75
2401cc to 3000cc	+50%	£67.50	£112.50	+50%	£101.25	£168.75
>3000cc	+200%	£135.00	£225.00	+50%	£202.50	£337.50

Business Permits Charges for Vehicles Registered Before 1 March 2001						
TABLE 5	First Vehicle per household			Second and subsequent vehicle		
Type of vehicle – Band by engine capacity	% change on current charge	2 hr Zone Base Price £140/year	Over 4 hr Zone Base Price £240/year	% increase to permit price	2 hr Zone Base Price £140/year	Over 4 hr Zone Base Price £240/year
<1000cc	-50%	£70.00	£120.00	+50%	£105.00	£180.00
1001cc to 1550cc	-30%	£98.00	£168.00	+50%	£147.00	£252.00
1551cc to 1800cc	-20%	£112.00	£192.00	+50%	£168.00	£288.00
1801cc to 2400cc	+10%	£154.00	£264.00	+50%	£231.00	£396.00
2401cc to 3000cc	+50%	£210.00	£360.00	+50%	£315.00	£540.00
>3000cc	+200%	£420.00	£720.00	+50%	£630.00	£1080.00

4. Parking Bays Across Dropped Kerbs Within CPZs

Within a CPZ, it is required that all lengths of the carriageway be marked with either a yellow line or a parking bay. This includes dropped kerbs outside individual properties.

Some households with dropped kerbs will wish this area to be kept clear, while others will prefer to park their car across it. If a CPZ is introduced the choice will be left to each household. Where a dropped kerb provides shared vehicular access, a yellow line will be installed across the dropped kerb.

Should the decision be taken to progress proposals for a CPZ in part or all of this area, this will involve further consultation with those residents with dropped kerbs on their preferred choice of a yellow line or parking bay in front of their dropped kerb.

5. Car Club provision in the London Borough of Richmond upon Thames

The Council is in the process of expanding Car Club provision in the Borough and is providing 73 new on street car club bays, 5 of which are in the area covered by this consultation. The locations are: Avondale Road (2 bays), Elm Bank Gardens (1 bay), Mortlake High Street (1 bay), and Thorne Street (1 bay).

The Car Club bays are being introduced under an Experimental Traffic Order and are subject to separate consultation arrangements, details of which can be obtained by contacting Mary Toffi on 020 8891 7379.

Car clubs are privately operated 'pool cars' and members of the club may be able to book a car as little as an hour before use. Bookings can usually be for an hour, for 2-3 days or longer and can be cheaper than conventional car hire. Bookings are typically made via the internet or phone and payment is generally by the hour and/or miles travelled.

For further information on how car clubs work, please call Carplus on 0113 234 9299 or visit their website at www.carplus.org.uk.

What Happens Next

The results of the consultation will be reported to a meeting of the Transport Consultative Group (TCG) on **Wednesday 27 May 2009** starting at **6.30pm** at the Sheen Lane Centre, Sheen Lane, East Sheen, following which a decision will be made on the way forward. The meeting of the TCG is open to the public and the agenda and report are available on the Council's website (www.richmond.gov.uk) 7 days before the date of the meeting. Anyone wishing to speak at the TCG meeting will need to register on **020 8891 7156** before 2pm on **Tuesday 26 May 2009**. Minutes of the meeting will be available on the Council website and on request.

How to Contact Us

Please return completed questionnaires and representations in writing in the prepaid envelope by **Friday 1 May 2009**. Alternatively you may wish to write to us at:

Address: Interim Head of Highways and Transport
London Borough of Richmond upon Thames
Environment Directorate
Civic Centre
44 York Street
Twickenham
TW1 3BZ

E-mail: [**highwaysandtransport@richmond.gov.uk**](mailto:highwaysandtransport@richmond.gov.uk)

If you would like a copy of this document in Braille, large print, on audiotape or in a community language, please contact us on: 08456 122 660.

Please note: due to the extent of the consultation the Council anticipates a large number of representations and therefore is unable to respond individually.

CPZ enquires: 08456 122 660

Parking permits: 020 8744 2131

For further information on CPZs please visit www.richmond.gov.uk/parking

**Please return enclosed questionnaire in prepaid envelope by
Friday 1 May 2009**