



"This map is reproduced from Ordnance Survey material with the permission of the Controller of Her Majesty's Stationery Office © Crown copyright. Unauthorised reproduction infringes Crown copyright and may lead to prosecution or civil proceedings 100019441 [2016]."

PROPOSED ZONE S3
EXTENSION AREA (1)

PROPOSED ZONE S3
EXTENSION AREA (2)

LEGEND

BOROUGH BOUNDARY

ST MARGARETS – EXISTING PARKING SCHEMES

ZONE S OPERATIONAL:
MON – FRI
10am – 4.30pm

ZONE S2 OPERATIONAL:
MON – FRI
10am – 4.30pm

ZONE S3 OPERATIONAL:
MON – FRI
10am – 12pm

DEC 2016 – CONSULTATION

PROPOSED ZONE S3
EXTENSION AREAS

ST MARGARETS ROAD AND
RAILSHEAD ROAD –
POSSIBLE INCLUSION IN
ZONE S3

NORMANHURST DRIVE –
POSSIBLE EXTENSION OF
ZONE S2

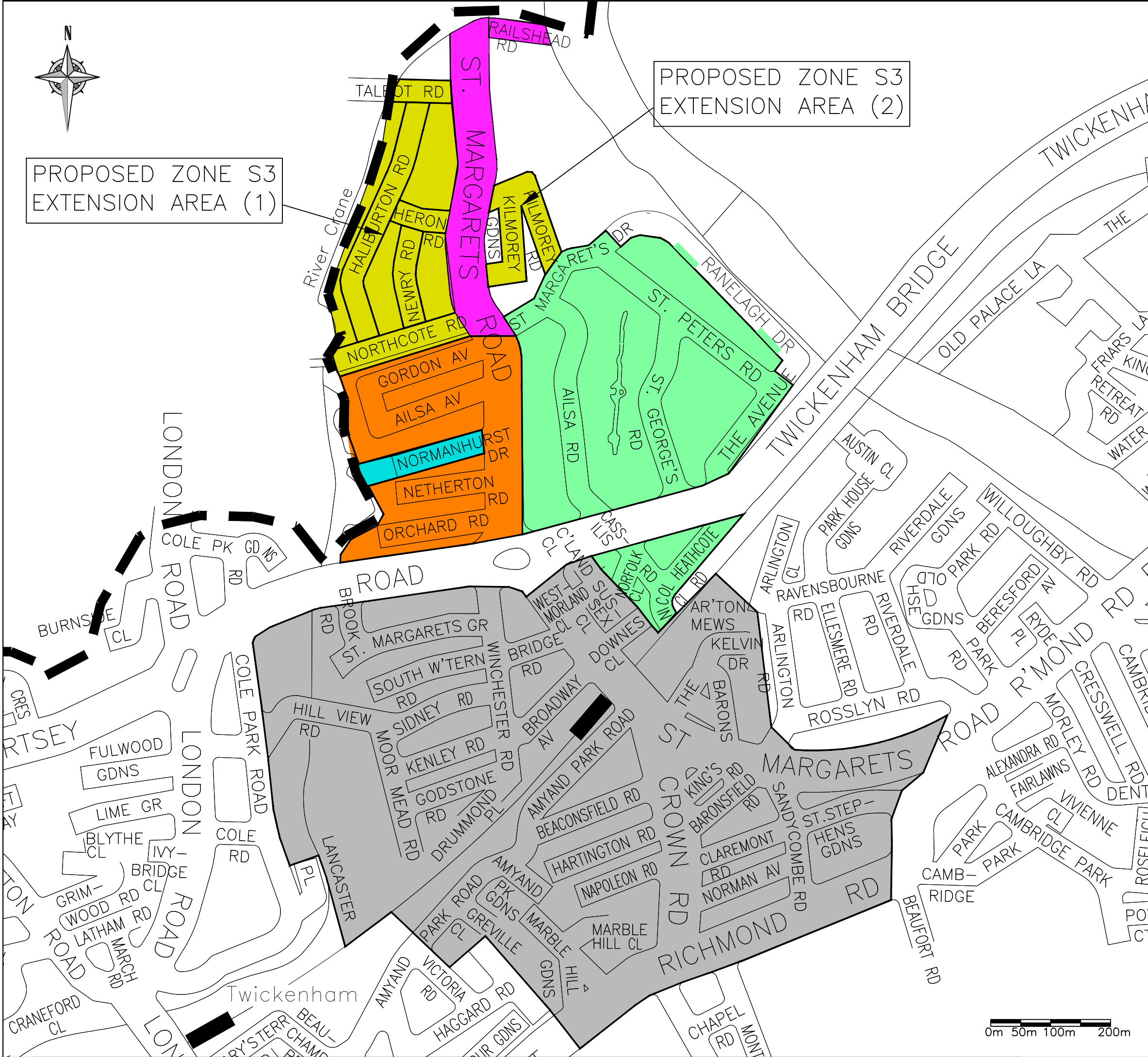

INITIAL ISSUE	T.S 10/2016	M.P 10/2016	M.P 10/2016	MP 10/2016
---------------	----------------	----------------	----------------	---------------

	DRAFT	SCALE (AT A3 SIZE) N.T.S
	ISSUE <input checked="" type="checkbox"/>	

CLIENT	LONDON BOROUGH OF RICHMOND UPON THAMES		
PROJECT	ST MARGARETS PARKING SCHEMES		
DRAWING TITLE	ZONES S2 AND S3 REVIEW CONSULTATION		

ISSUING OFFICE	TWICKENHAM	DRAWING NUMBER	2318-S2S3-011116	REVISION	-
TELEPHONE	020 88911411				

