

# Hippo Water-Saver

## What is a Hippo?

A Hippo is a small plastic bag which can easily be fitted into your toilet cistern. Water is retained in the bag, helping to save water every time you flush.

## Why should I use a Hippo?

Almost a third of the water we use at home is flushed down our toilets.

Fitting a Hippo device in the average cistern will save up to 3 litres of water with every flush. If one toilet is flushed ten times a day, this would equate to a water saving of 30 litres per day, enough water for a five-minute shower!



## How do I install a Hippo?

Fitting your Hippo will take just a few minutes. Just follow the simple steps below:

1. Put both hands inside the Hippo and push out the corners to create a box shape.
2. Turn the Hippo upside-down and place the open end over the cistern ball float.
3. Now turn the Hippo over so that it is immersed in the water with the ball float inside its open end. Flood the Hippo by pushing down with one hand placed inside.
4. Flush the toilet in the normal manner whilst simultaneously pouring 3-4 litres (5-7 pints) of water into the Hippo. After a number of flushes over a 48-hour period the Hippo will settle in.

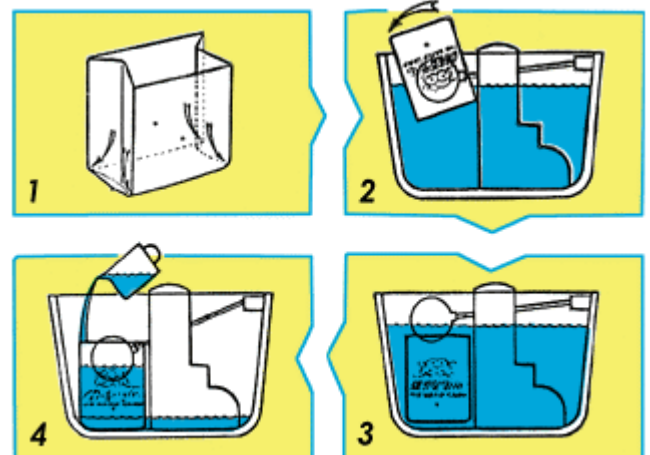

## Cisterns with 'Micro floats'

If your cistern is fitted with a small micro float and not the usual large plastic ball float then, before fitting the Hippo, unclip the float taking note of its location and hold the float arm up to prevent over-filling. Immerse the Hippo as instructed above and clip the float back into its former position. Then follow the instructions in diagram 4.

**With a Hippo installed, flushing performance should not change. However, Hippos may not be suitable for some toilets.**

Dual-flush toilets and slimline toilets which have been installed since the beginning of 1999 are already water-efficient since they are designed to use less water per flush. Installing a Hippo in these toilets may reduce the flush too far so that the toilet is not cleaned properly. If you have a toilet cistern with a 7-9 litre flush (usually installed 1993-1999), you should use a Save-a-Flush bag.

## What should I do if the toilet won't flush properly with a Hippo fitted?

If you feel that your toilet needs more water, then remove the Hippo, since it wastes water if the toilet needs to be flushed more than once.