

ROAD TRAFFIC REGULATION ACT 1984

**THE LONDON BOROUGH OF RICHMOND UPON THAMES (HAMPTON WICK)
(PARKING PLACES) (AMENDMENT No. **) ORDER 201***

PARK ROAD, HAMPTON WICK

(Reference 50/12)

1. The Council of the London Borough of Richmond upon Thames proposes to make the above Order under sections 45, 46, 49 and 124 of, and Part IV of Schedule 9 to, the Road Traffic Regulation Act 1984, as amended.
2. The general effect of the Order will be to shorten by a length of 5 metres a parking place on the south-west side of Park Road and to introduce on the north-east side a new parking place having a length of 5 metres. In each case, the parking place is reserved for resident permit holders only, and the location of the alterations is in the vicinity of No 38 Park Road, between its junctions with School Road and Church Grove.
3. Copies of the proposed Order, a plan showing the location and effect of the proposals and the Council's Statement of Reasons for proposing to make the Order:-
 - (a) can be inspected, quoting Reference 50/12, at the Civic Centre (Central Reception, ground floor), 44 York Street, Twickenham between 9.15am and 5pm on Mondays to Fridays, except for Bank and other public holidays; and
 - (b) may be viewed on the Council's web-site at http://www.richmond.gov.uk/traffic_management_orders.htm
4. Persons wishing to object to or support the proposals or any part thereof should write to the Head of Highways and Transport, Civic Centre, 44 York Street, Twickenham TW1 3BZ within 21 days of the date of this Notice giving the grounds of their objection. Emails may be sent to highwaysandtransport@richmond.gov.uk.

ANDREW DARVILL
Assistant Director, Traffic and Transport

Dated 16 November 2012

PARKING PLACES ORDER

THE LONDON BOROUGH OF RICHMOND UPON THAMES (HAMPTON WICK) (PARKING PLACES) (AMENDMENT No. **) ORDER 201*

Made: ***

Coming into operation: ***

The Council of the London Borough of Richmond upon Thames, having consulted the Commissioner of Police of the Metropolis, in exercise of the powers conferred by Sections 45, 46, 49 and 124 of, and Part IV of Schedule 9 to, the Road Traffic Regulation Act 1984(a), as amended, and all other enabling powers hereby make the following Order—

1. This Order shall come into operation on *** and may be cited as the London Borough of Richmond upon Thames (Hampton Wick) (Parking Places) (Amendment No. **) Order 201*.
2.
 - (1) In this Order the expression “enactment” means any enactment whether public, general or local and includes any order, bye-law, rule, regulation, scheme or other instrument having effect by virtue of an enactment.
 - (2) Any reference in this Order to any enactment shall be construed as a reference to that enactment as amended, applied, consolidated, re-enacted by or as having effect by virtue of any subsequent enactment.
 - (3) The Interpretation Act 1978(b) shall apply for the interpretation of this Order as it applies for the interpretation of an Act of Parliament.
3. Without prejudice to the validity of anything done or to any liability incurred in respect of any act or omission before the coming into operation of this Order, the London Borough of Richmond upon Thames (Hampton Wick) (Parking Places) Order 1994(c), as amended, shall have effect as though:-
 - (a) there were added to the items in Schedule 7 to that Order the item numbered 7/15A and set out in columns 1, 2, 3, 4 and 5 of Schedule 1 to this Order; and
 - (b) for the numbered 7/17 in Schedule 7 to that Order there were substituted the item similarly numbered and set out in columns 1, 2, 3, 4 and 5 of Schedule 2 to this Order.

Dated ****

Assistant Director, Traffic and Transport
(The officer appointed for this purpose)

(a) 1984 c. 27. (b) 1978 c. 30. (c) 1994/14 – there are no relevant amending orders

SCHEDULE 1
(See Article 3(a))

ITEM TO BE ADDED TO SCHEDULE 7 [to 1994/14]

IN RELATION TO A PARKING PLACE REFERRED TO IN THIS SCHEDULE THE EXPRESSION "PERMITTED HOURS" MEANS THE PERIOD BETWEEN 8.30 AM AND 6.30 PM ON MONDAYS TO SATURDAYS INCLUSIVE, ANY SUCH DAY NOT BEING CHRISTMAS DAY, GOOD FRIDAY OR A BANK HOLIDAY.

PARKING PLACES IN WHICH A VEHICLE MAY BE LEFT DURING THE PERMITTED HOURS IF IT DISPLAYS A VALID RESIDENTS', RESIDENTS' VISITORS OR OPERATIONAL PERMIT.

1 No. of parking place	2 Designated parking place	3 Maximum number of parking bays	4 Minimum total length in metres not to be occupied by parking bays	5 Special manner of standing
7/15A	PARK ROAD, Hampton Wick, the north-east side, from a point opposite the south-eastern flank wall of No 38 Park Road north-westwards for a distance of 5 metres.	1	-	-

SCHEDULE 2
(See Article 3(b))

ITEM TO BE SUBSTITUTED IN SCHEDULE 7 [to 1994/14]

IN RELATION TO A PARKING PLACE REFERRED TO IN THIS SCHEDULE THE EXPRESSION "PERMITTED HOURS" MEANS THE PERIOD BETWEEN 8.30 AM AND 6.30 PM ON MONDAYS TO SATURDAYS INCLUSIVE, ANY SUCH DAY NOT BEING CHRISTMAS DAY, GOOD FRIDAY OR A BANK HOLIDAY.

PARKING PLACES IN WHICH A VEHICLE MAY BE LEFT DURING THE PERMITTED HOURS IF IT DISPLAYS A VALID RESIDENTS', RESIDENTS' VISITORS OR OPERATIONAL PERMIT.

1 No. of parking place	2 Designated parking place	3 Maximum number of parking bays	4 Minimum total length in metres not to be occupied by parking bays	5 Special manner of standing
7/17	PARK ROAD, Hampton Wick, the south side, from a point 5 metres north-west of a point opposite the north-western flank wall of No 38 Park Road to a point opposite the common boundary of Nos 40A and 40B Park Road.			

EXPLANATORY NOTE

(This Note is not part of the Order but is intended to indicate its general purport.)

This Order shortens an existing parking place on the south-west side of Park Road by a length of 5 metres and introduces a new parking bay on the north-east side of Park Road having a length of 5 metres. The new bay is outside No 38 Park Road and is nearly, but not exactly, opposite the position of the parking place which has been shortened.

ROAD TRAFFIC REGULATION ACT 1984

THE LONDON BOROUGH OF RICHMOND UPON THAMES (HAMPTON WICK) (PARKING PLACES) (AMENDMENT No. **) ORDER 201*

STATEMENT OF REASONS FOR PROPOSING TO MAKE THIS ORDER

Concerns have been raised from local residents in respect of vehicles which have been observed illegally entering the one-way system in Park Road. The current layout allows drivers travelling from Sandy Lane /Church Grove a clear line of sight, enabling them to consider the possibility of illegally entering the one-way zone. Offenders have been observed entering the one-way street the wrong way and then proceeding at speed in attempts to avoid potential traffic conflicts.

To deter these illegal traffic movements, it is proposed to offset the current parking arrangement. By creating a slight stagger effect, the direct line of sight is broken whilst still allowing large vehicles such as refuse and removal lorries to adequately manoeuvre in Park Road.

Date 16 November 2012

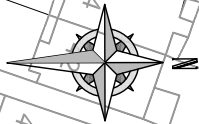

EXISTING RESTRICTION TO BE REVOKED AND RESIDENT PERMIT BAY TO BE INSTALLED

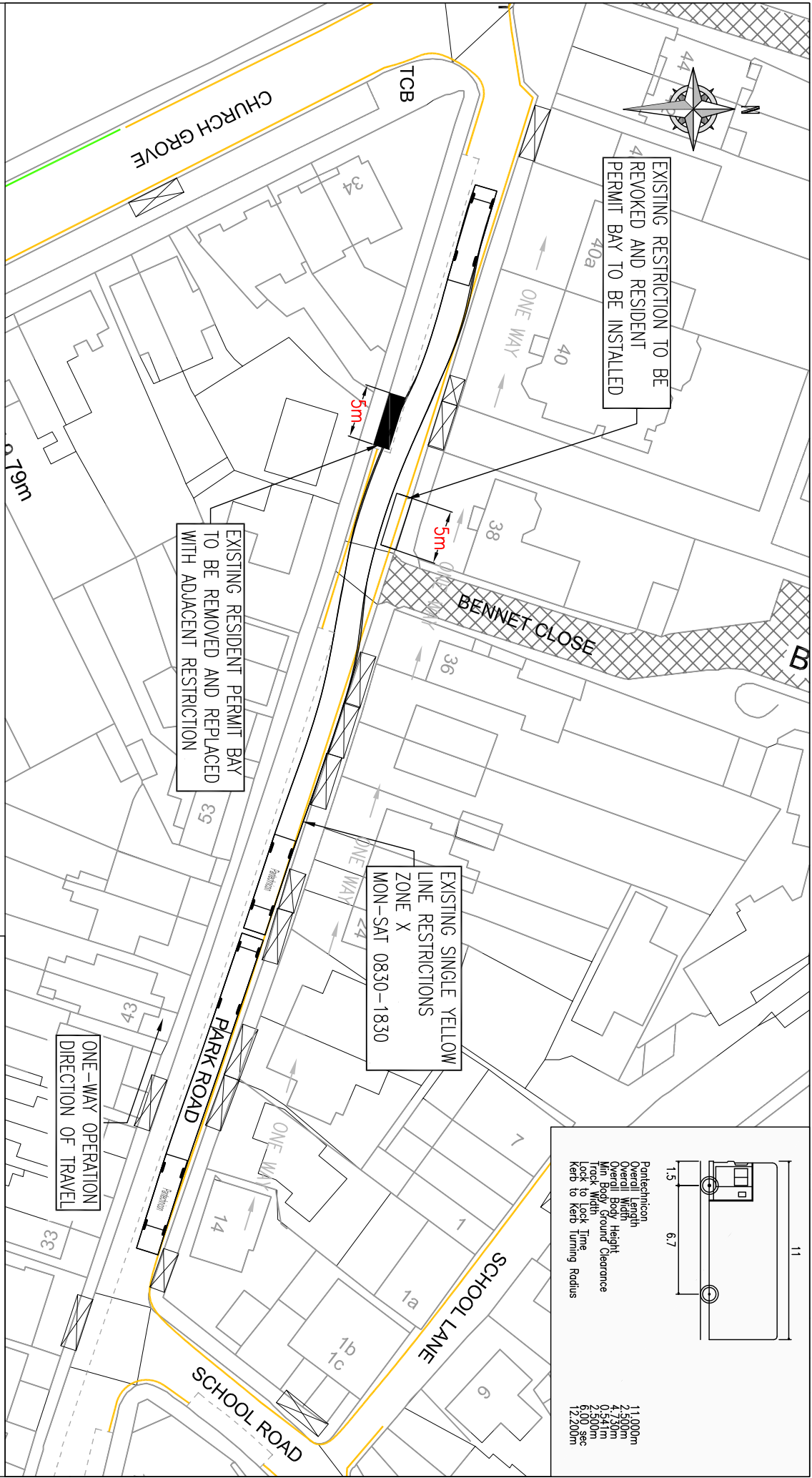

Permitted	11,000mm
Overall Length	2,500mm
Overall Width	4,230mm
Min Body Ground Clearance	9,441mm
Min Body Width	2,300mm
Lock to Lock	6,200mm
Turning Radius	12,200mm

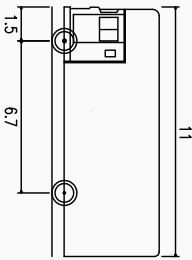

"This map is reproduced from Ordnance Survey material with the permission of the Controller of Her Majesty's Stationery Office © Crown copyright. Unauthorised reproduction infringes Crown copyright and may lead to prosecution or civil proceedings 100019441 [2012]."

REVISION	-	RY	RY	LF	MT	Issue	Draft
		SEP 2012	AUG 2012	OCT 2012	OCT 2012	Scale (of A4 size)	
		DRAWN BY & DATE	DESIGNED BY & DATE	CHECKED BY & DATE	APPROVED BY & DATE	1:1000	

CLIENT	LONDON BOROUGH OF RICHMOND UPON THAMES	ISSUING OFFICE	TWICKENHAM	DRAWING NUMBER	2297-CS-001	REVISION	-
PROJECT	INFORMATION DRAWING	TELEPHONE	020 88911411				
DRAWING TITLE	PROPOSED CHANGES						
	PARK ROAD, HAMPTON WICK						